



## ET65

Tracked Conventional Tail Excavators



### Performance and economic efficiency perfectly combined: ET65

The ET65 is an excavator like end users want it to be. A highly efficient machine that surprises with its compact design and maneuverability. Thanks to the high digging power and the powerful engine, the strong excavation performance is added bonus points that make the excavator into an all-rounder on the construction site. With the articulated boom, it also has a large reach, digging depth and dumping height.

- Precise and sensitive operation thanks to the load sensing hydraulic system with LUDV (load-independent flow control)\*!
- Low consumption due to the economical ECO mode
- Up to 5 auxiliary control circuits for the most varied attachments
- Extremely compact and maneuverable
- Maintenance and service made easy due to the tiltable cabin as well as the diagnostic tool

\* Load-independent flow distribution

Economical and powerful

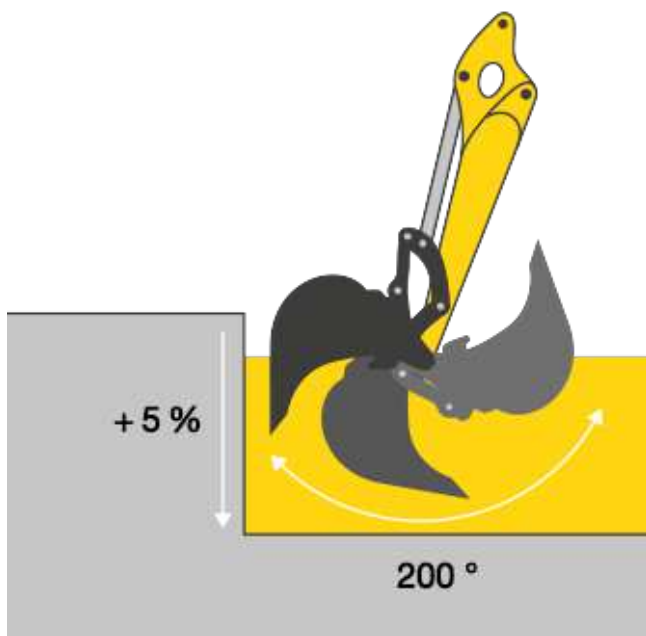

- Optimal force distribution when excavating and up to 20% more breakaway force: plunge in deeper and excavate more powerfully
- Less material loss in the bucket due to an expanded angle of rotation of 200 degrees
- Articulated boom for greater reach, digging depth and dumping height
- Up to 20% less fuel consumption



#### Reduced dimensions

- Significantly lower height and width than comparable competition models
- Easily master tight construction sites and low passages
- Higher level of stability due to the low center of gravity
- Easy to transport

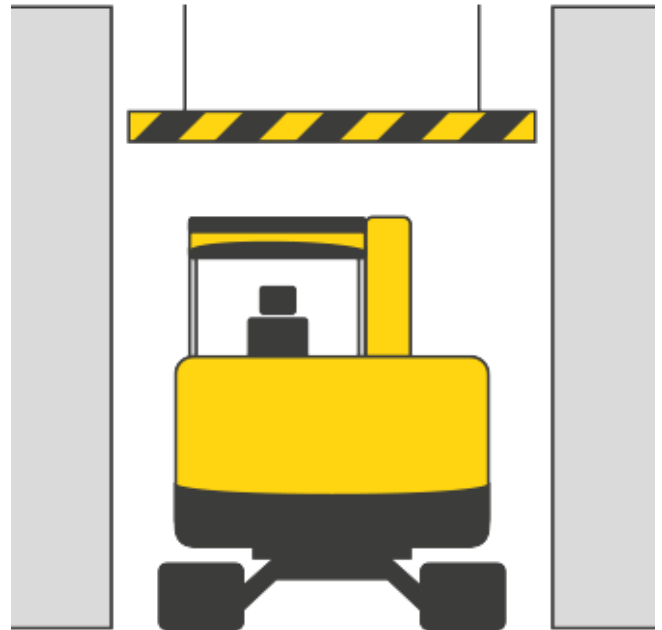

#### Cabin, sight and operating comfort

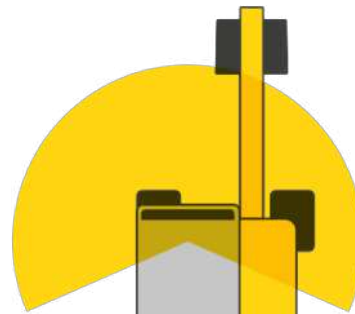

- Innovative solution for the optimal view – boom to the right next to the cabin
- Operator comfort: spacious cabin, air cushioned seat and automatic air-conditioning system
- Innovative front windshield system: two-part windshield can be slid up and moved - rain roof position
- LED headlights for optimal illumination
- Rear camera for more safety when in reverse operation



Jog dial system

- Technology from the automotive sector
- For the direct control of central functions
- Intuitive to operate





## Technical specifications

### Operating data

|                                 |                          |
|---------------------------------|--------------------------|
| Shipping weight min.            | 6,460 kg                 |
| Operating weight min.           | 6,600 kg                 |
| Biting force max. (ISO 6015)    | 28 kN                    |
| Breakaway force max. (ISO 6015) | 54.1 kN                  |
| Digging depth max.              | 4,193 mm                 |
| Dumping height max.             | 4,898 mm                 |
| Digging radius max.             | 6,877 mm                 |
| Superstructure slewing speed    | 9 1/min                  |
| L x W x H                       | 6,194 x 1,950 x 2,478 mm |

### Engine / Motor

|                                     |  |
|-------------------------------------|--|
| Engine / Motor manufacturer         | Perkins                                    |
| Engine / Motor type                 | 404F-22T                                   |
| Engine / Motor                      | Liquid-cooled 4-cycle turbo in-line engine |
| Displacement                        | 2,216 cm <sup>3</sup>                      |
| RPM / speed                         | 2,000 rpm                                  |
| Engine performance according to ISO | 36.2 kW                                    |
| Battery                             | 88 Ah                                      |
| Tank capacity                       | 85 l                                       |

### Hydraulic system

|   |  |
|---|--|
| Duty pump   | Variable displacement pump and gear pump |
| Flow rate   | 144 l/min                                |
| Operating pressure for working and driving hydraulics | 240 bar                                  |
| Operating pressure swing gear                         | 215 bar                                  |
| Hydraulic oil tank                                    | 92 l                                     |

### Wheel set

|                   |          |
|-------------------|----------|
| Travel speed max. | 5.2 km/h |
| Chain width       | 400 mm   |
| Ground clearance  | 204 mm   |



Dozer Blade

|                                   |        |
|-----------------------------------|--------|
| Stroke dozer blade above subgrade | 403 mm |
| Stroke dozer blade below subgrade | 427 mm |

Sound level

|   |          |
|---|----------|
| Sound level (LwA) according to 2000/14/EC | 98 dB(A) |
|---|----------|



## Dimensions

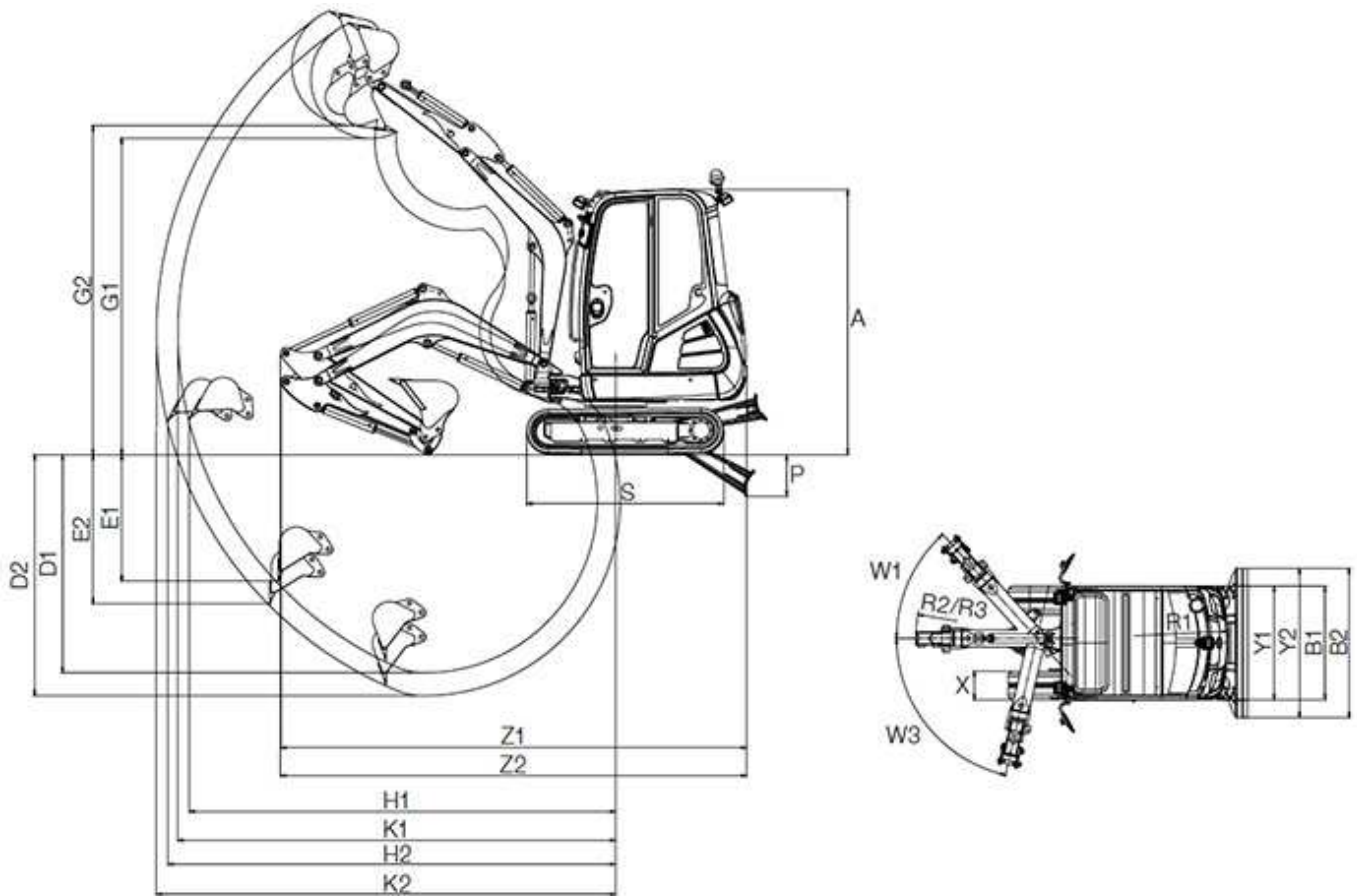

ds = dipper stick

### Please note

that product availability can vary from country to country. It is possible that information / products may not be available in your country. More detailed information on engine power can be found in the operator's manual; the stated power may vary due to specific operating conditions.

Subject to alterations and errors excepted. Applicable also to illustrations.

Copyright © 2015 Wacker Neuson SE.